



Bylaw No. 665, 2019

A bylaw to regulate the numbering of buildings and structures for North Coast Regional District Electoral Area D.

WHEREAS the Extended Service House Numbering Bylaw No. 244, 1994 authorizes the North Coast Regional District to number buildings and name streets within the District;

AND WHEREAS the Board of the North Coast Regional District wishes to establish a bylaw that regulates the numbering of buildings and naming of streets;

AND WHEREAS, pursuant to section 329 of the *Local Government Act*, the Board of the North Coast Regional District may, by bylaw, require owners or occupiers of real property to place building or structure numbers assigned by the regional district in a conspicuous place;

NOW THEREFORE the North Coast Regional District, in open meeting assembled, enacts as follows:

1. CITATION

- a) This bylaw may be cited as “*North Coast Regional District Electoral Area D Civic Addressing Bylaw No. 665, 2019*”.

2. GEOGRAPHICAL AREA

- a) A system of house numbering and street naming is hereby adopted for Electoral Area D excluding member municipalities.

3. NUMBERING

- a) Odd house numbers are located on the east and north side of the road.
- b) Even house numbers are located on the west and south side of the road.
- c) House numbers increase from fixed zero starting points:
 - i. Skidegate Landing Ferry Dock is the zero start for Highway 16 Corridor
 - ii. Masset causeway is the zero start for Tow Hill Road
- d) House numbers are assigned by driveway access to the street.
- e) Civic addresses will only use numerical values, not alphanumerical.
- f) Strata and multi-family developments will be assigned a single civic address; units of development will then be assigned numerical unit numbers.
- g) Multi-storey buildings shall have the unit numbers correlate to the floor on which the units are located. Units on the first floor or ground level are to be numbered in the 100 series, units on the second floor in the 200 series and so forth. Any exceptions to this are to be approved in advance by the Regional District in consultation with the relevant local fire department.
- h) New addresses will be assigned by measuring distance in metres to property access

4. DISPLAYING ADDRESSES

- a) Numbers assigned to buildings and structures that are displayed shall be so placed as to be easily read from the road upon which such building or structure is deemed to front as indicated by the numbers assigned.
- b) Displayed civic addresses must be displayed as numbers; not text or roman numerals.
- c) The numerals used to display the civic number shall have a contrasting background and be clearly visible from the road both day and night.

5. STREET NAMING

- a) Naming of streets is as shown on 'Schedule A', 'Schedule B', and 'Schedule C' attached to and forms part of this bylaw.

Bylaw 665 Schedule A, Graham Island - Tow Hill

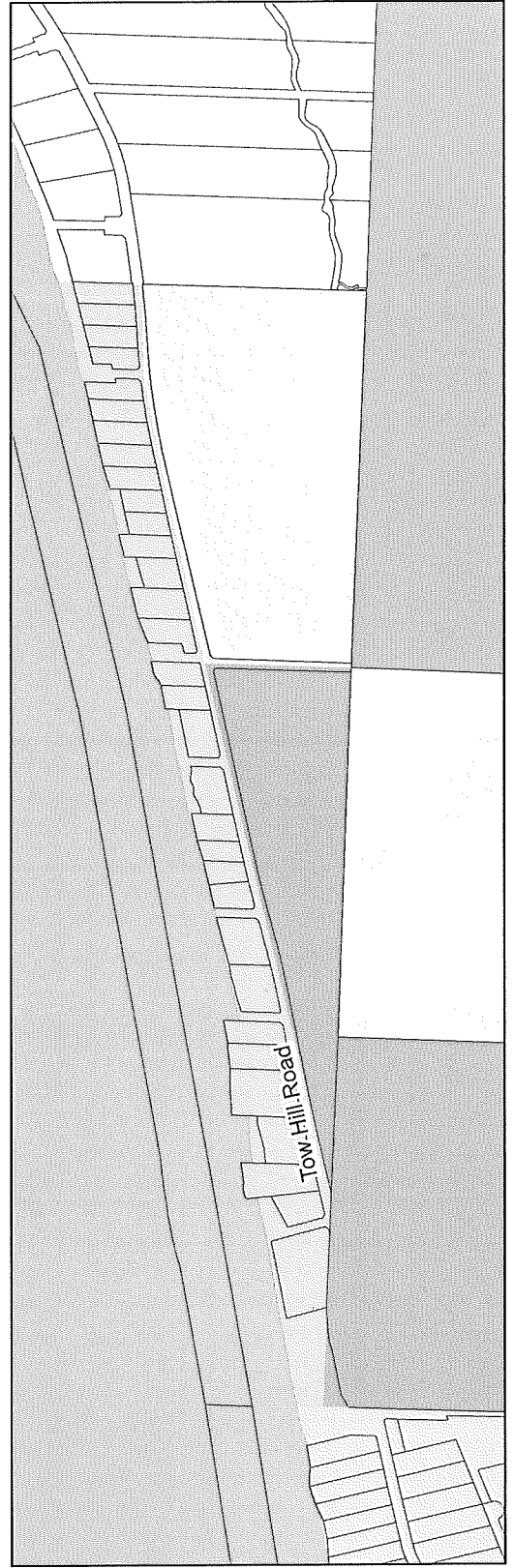
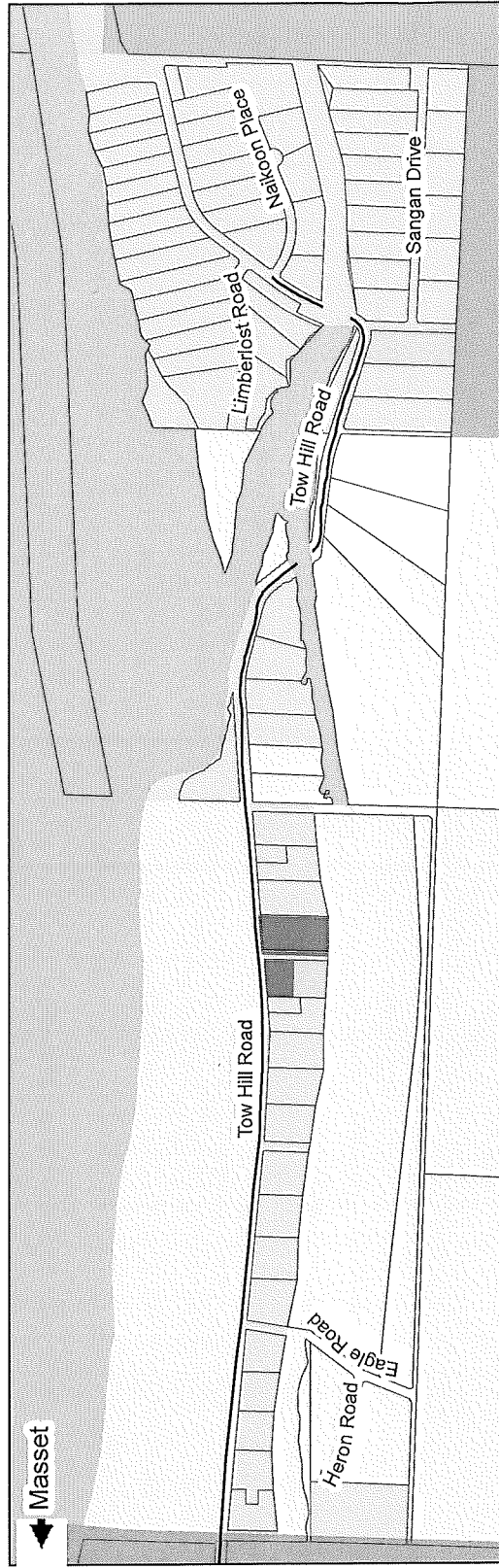

Bylaw 665 Schedule B, Graham Island

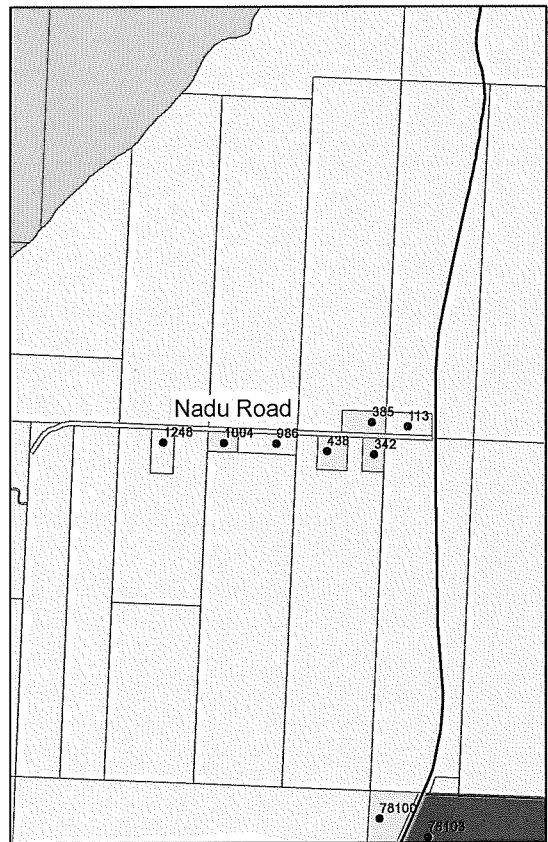
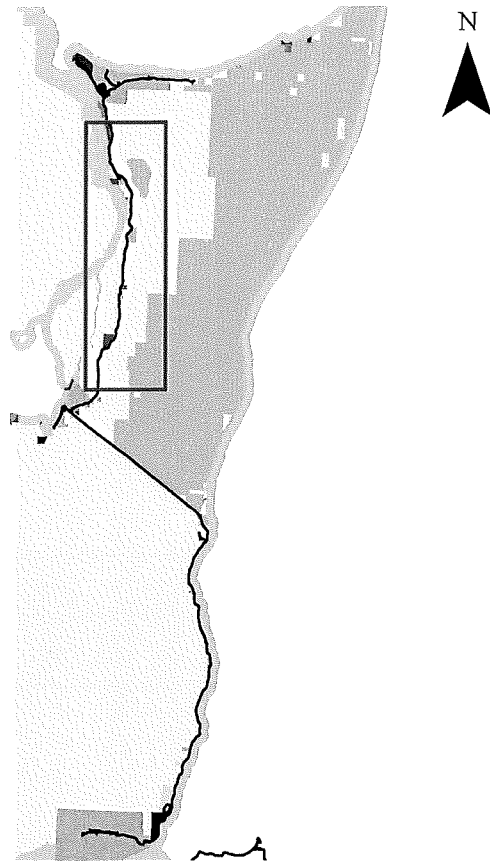
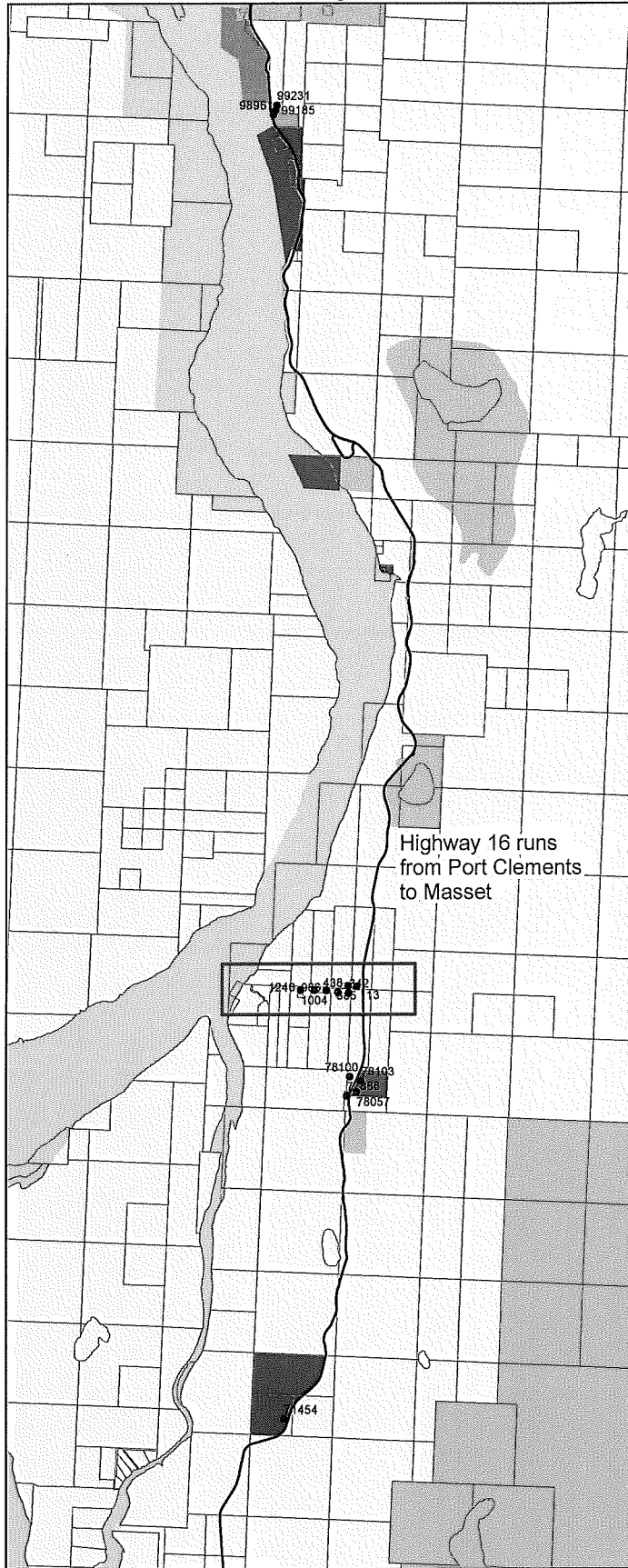

Bylaw 665 Schedule C, Graham Island

